

SPECIFICATIONS

AO Medium		TeO2
Acoustic Velocity		4.2 mm/μs
Active Aperture*	2.5 mm 'L' X	1.5 mm 'H'
Center Frequency (Fc)		200 MHz
RF Bandwidth	50 MHz @	-10 dB Return Loss
Input Impedance		50 Ohms Nominal
VSWR @ Fc		1.3 :1 Max
Wavelength		470-690 nm
Insertion Loss		4 % Max
Reflectivity per Surface		1 % Max
Anti-Reflection Coating		MIL-C-48497
Optical Power Density		250 W/mm ²
Contrast Ratio		1000 :1 Min
Polarization		90 ° To Mounting Plane

PERFORMANCE VS WAVELENGTH

Wavelength (nm)	470	532	633	690
Saturation RF Power (W)	0.4	0.6	0.9	1.1
Bragg Angle (mr)	11.2	12.7	15.1	16.4
Beam Separation (mr)	22.4	25.4	30.2	32.8

PERFORMANCE VS BEAM DIAMETER

Beam Diameter (μm)	1000	1000	1000	1000
<i>at Wavelength (nm)</i>	470	532	633	690
Diffraction Efficiency (%)	85	85	85	85
Rise Time (nsec)	159	159	159	159

Outline Drawing:

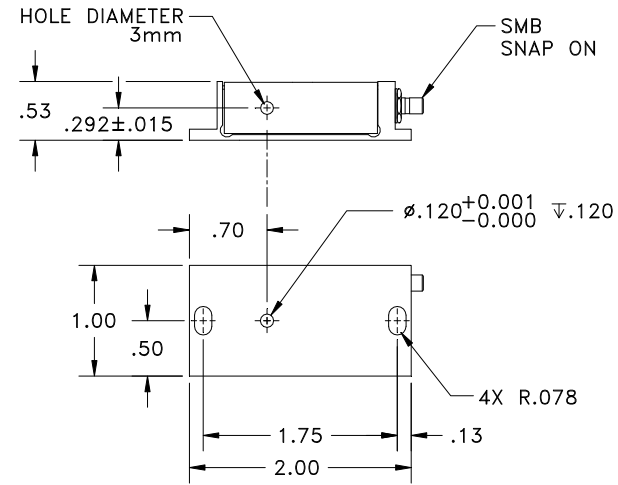

Document
10/31/13
Control

Notes:
1) All dimensions in inches unless specified otherwise.
2) cover Nickel plated

THIS DOCUMENT IS THE PROPERTY OF GOOCH AND HOUSEGO. IT IS NOT TO BE REPRODUCED OR DISCLOSED IN WHOLE OR IN PART OTHER THAN BY EMPLOYEES OF GOOCH AND HOUSEGO AND ITS CONTRACTED REPRESENTATIVES AND DISTRIBUTORS. ANY EXCEPTION REQUIRES THE WRITTEN CONSENT OF AN AUTHORIZED REPRESENTATIVE OF GOOCH AND HOUSEGO.

TOLERANCES: .XX ± .01 .XXX ± .005	DR	T. NG 10/8/2013	 AOMO 3200-1214 200 MHz Frequency Shifter
MATERIAL:	CHK		
FINISH:	APP		
	APP	PART NUMBER: 97-03036-02	REV: 2
			SHEET 1 OF 1

*Active Aperture: Aperture over which performance specifications apply.